

Safety blood collection needles

BD Vacutainer® Eclipse™ Signal™ Blood Collection Needle

BD Vacutainer® Eclipse™ Signal™ Blood Collection Needle offers a combination of proven robust safety technology with the additional benefit of in-vein confirmation. This results in ease of use and confidence during venous blood collection, increasing both healthcare worker and patient safety.

- Indication of successful venepuncture:
Instaflash™ provides in-vein confirmation of when the vein has been successfully penetrated.
- Increased protection for both healthcare workers and patients:
The single-handed activation of the safety mechanism allows greater attention to be paid to the patient and venepuncture site. Blood droplet reduction technology pulls blood away from the end of the needle.



NEW



- More efficient blood collection:
The extra thin cannula wall has a larger inner diameter (vs. thin wall cannula of the same gauge) allowing blood to flow faster through the device.

Further information

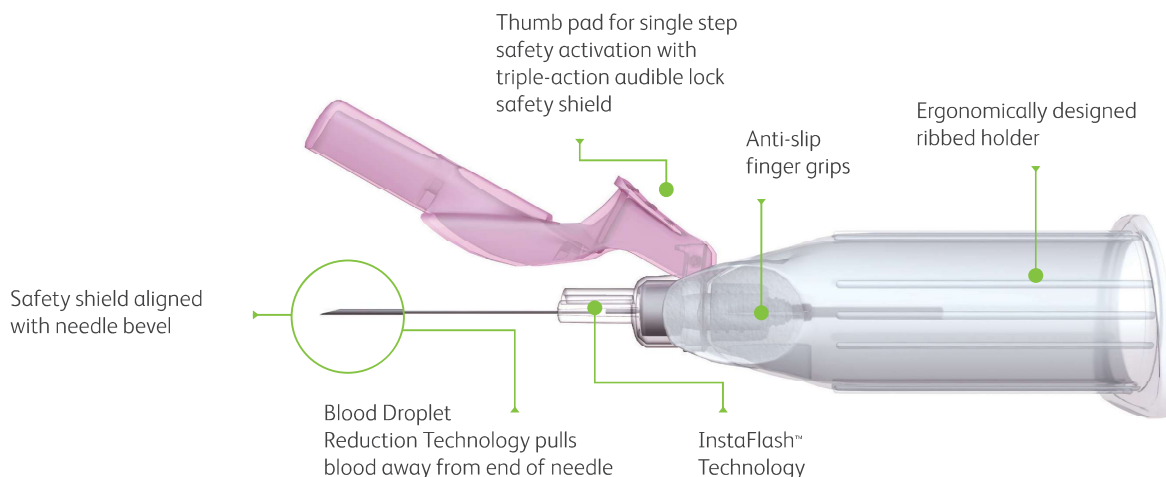
Technical information is available on request.



BD Vacutainer® Eclipse™ Signal™ Blood Collection Needles with Integrated Holder

Cat. no.	NHS code	Size	Needle length	Colour code	Box/case
368835	KFK517	21G (0.8mm)	25mm (1")		50/400
368836	KFK518	22G (0.7mm)	25mm (1")		50/400